

XRAY XT8 SUPPLEMENTARY SHEET

This kit includes reinforced Front & Rear Diff Bulkheads and Diff Height Inserts featuring new Labyrinth Dust Covers. Please follow these supplemental instructions during related assembly steps.

NEW BULKHEADS & HUBS

NEW Reinforced Design
NEW Labyrinth Design

NEW Labyrinth Design

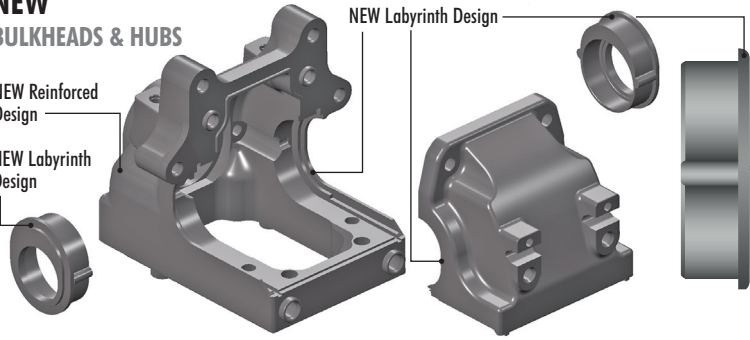

BALL-BEARING HUB POSITIONS

LOWER

CENTER

UPPER



Cut off burr

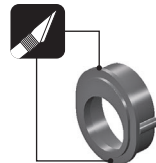

Cut off burr

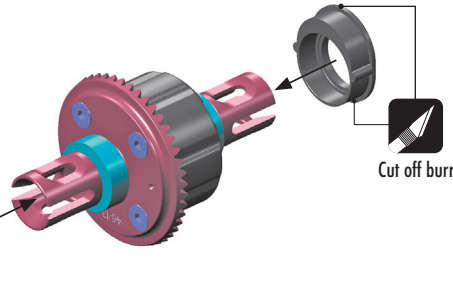

908312
SCH M3x12

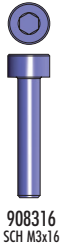

908316
SCH M3x16

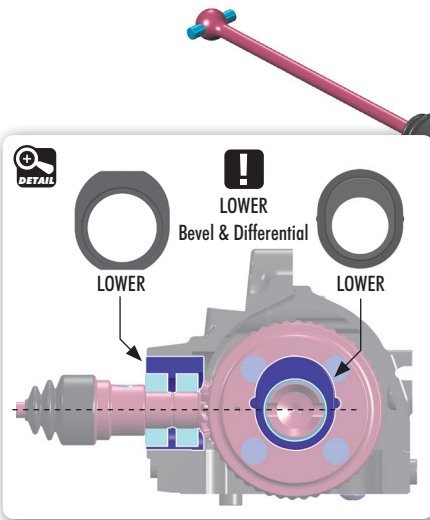

! During assembly, there may be some differential movement in the bulkhead. In particular, DO NOT check mesh or diff movement without installing suspension holders and securing bulkhead to the chassis. All parts have specifically designed tolerances, and only when the car is fully assembled will it have the proper amount of play where necessary. Check for free movement of all rotational driveline components once the driveline and suspension are completely assembled, as well as non-binding operation of the suspension components.

4
TIGHTEN
3x16mm SCREWS SECOND

HUB
GR

3
TIGHTEN
3x12mm SCREWS FIRST

INSTALLING THE DIFFERENTIAL WHILE FIRST TIME BUILDING THE CAR

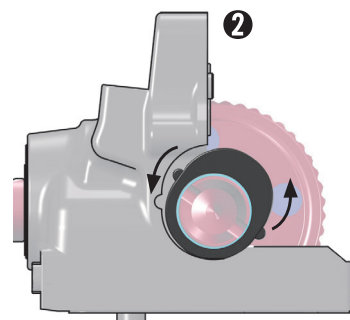
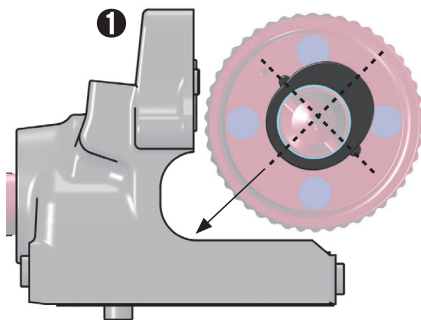

Check that left and right Diff Height Inserts are installed in the same orientation.

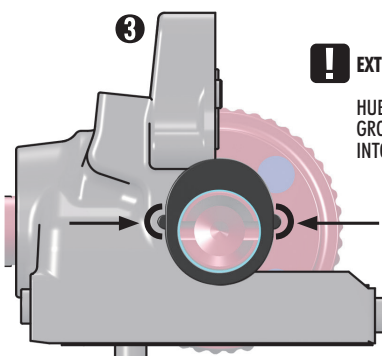

! EXTREMELY IMPORTANT
HUB MUST BE INSERTED IN GROOVE AND PROPERLY PRESSED INTO BULKHEAD.

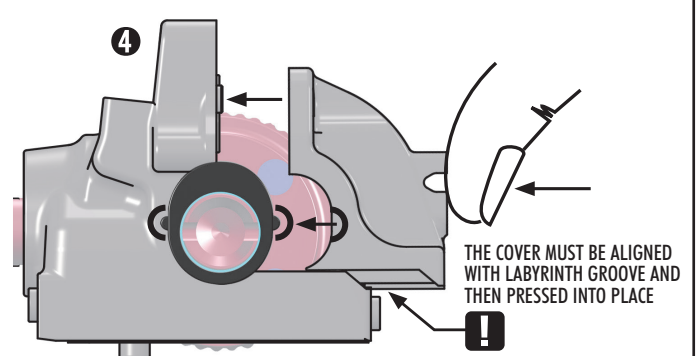

THE COVER MUST BE ALIGNED WITH LABYRINTH GROOVE AND THEN PRESSED INTO PLACE

REMOVING THE DIFFERENTIAL WHEN CAR IS ASSEMBLED

FRONT & REAR

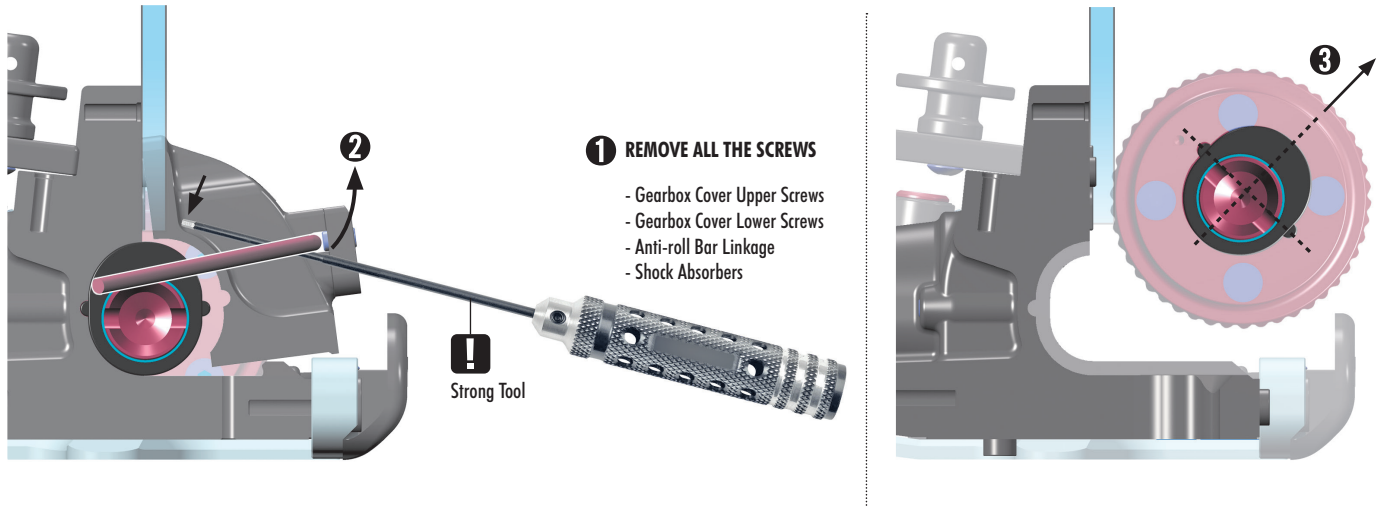

INSTALLING THE DIFFERENTIAL WHEN CAR IS ASSEMBLED

FRONT & REAR

