

Name: Matthew Williby

Date: Feb 2020 Event: Club Racing



City: Huntington Beach State: CA

Track: OCRC Raceway

Track Dirt Carpet Tight Smooth Hard Packed Dry Grip Level: Low Medium High
Conditions: Clay Astro Turf Open Rough Loamy Wet Tread Level: Pin Ghost Pin Slicks

Front Suspension

Toe: +0 deg Camber: -1.0 deg
Ride Height: 22mm Caster Block: 0° 5°
Kick Shim(s): 2mm 1mm Wedge(20°) Other:
VLA Setting: Short Arm Long Arm
Front Pivot: Alum Composite Brass
Pivot Height: SLRC LRC MRC HRC
Piston: 1.6/1.7 Split (standard) Oil: 32.5wt
Limiters: Internal: 1mm External: - Stroke: 22mm
Shock Eyelet: Std. +2 Shock Location: 2 - Middle
Spring: LF Blue Sway Bar: 1.0
Spindle Steering Arm: 4 5 6
Spindle Ball Stud: Standard Low Spacers: 1mm
Draglink Ball Stud: Standard Low Spacers: -
Axle Spacing: 0 +.5mm +1mm
Trail: 2mm 3mm 4mm
Camber Link, Inner: 1 2 3 Outer: A B
Tower: Stiffezel Carbon Carbon +2mm
Mud Guard: Soft Standard Stiffezel
Front Wheels: Standard Stiffezel
Front Wing: Low High Narrow High Wide

Stiffezel Parts:

Front Arm Rear Arm
 Chassis Brace/Waterfall

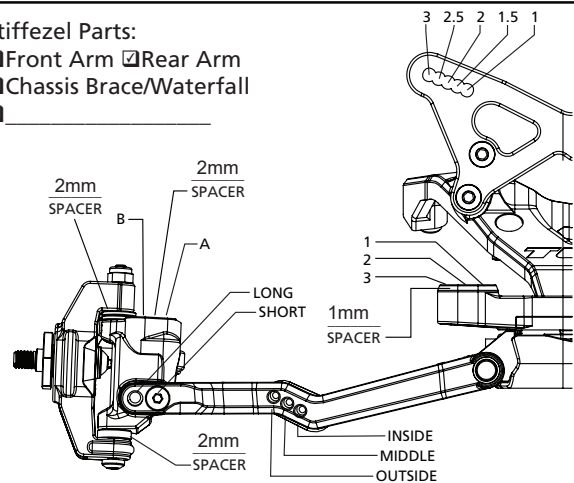

Notes: TiCN Shock Shafts, SR Drivetrain

Rear Suspension

Configuration: Laydown Standup
Diff. Height: 0 +1 +1.75 +2.5 +3.5
Axle Height: 0 +1 +2 +3 +4
Ride Height: 22mm Camber: -1 deg
Hub Spacing: 1.5mm Fr 1.5mm Rr Hex Width: 5.5 (22X)
Piston: 2 x 1.7mm (standard) Oil: 30wt
Spring: ASC91838 V2 White Sway Bar: -
Limiters: Internal: 1mm External: - Stroke: 29mm
Shock Eyelet: Std. +2 Shock Location: 2 - Middle
Shock Mounting: Front Rear Shaft Dia.: 3.0 3.5
Tower: Stiffezel Carbon Carbon +2mm
Camber Block Spacer: 1mm ↓ 0mm 1mm ↑
Camber Link, Inner: 1 2 3
Camber Link, Outer: A B C
Battery Position: 1 2 3 4 5
Wing/Wickerbill: TLR 6.5", no wicker
Wing Angle: 0° 2° 4° Wing Height:
Diff Type: Ball Gear Setting: Normal, 1 rotation
Gear Diff Gears: Composite Steel Planet Gears: 2 4
Driveshaft Length: CVA Universal Length: Alum SR
CV Pin Position: 1 2 3 4
 Direct Drive Slipper Pads: Torque (yel) Drive (org)

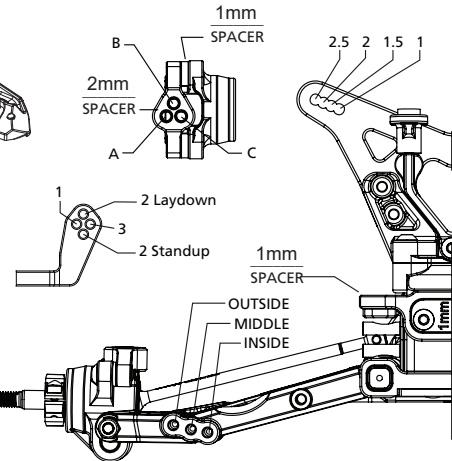
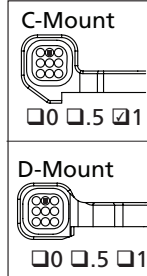
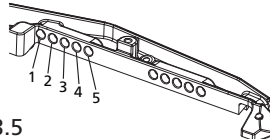
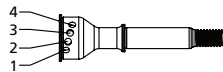

Electronics

Radio: Sanwa M12 Timing Advance: Blinky
Servo: SPMS6420 Steering Expo: -
ESC: Hobbywing Stock Spec Throttle/Brake EPA: 100/50
Initial Brake: 0 Motor: Schuur Speed V4 17.5T
Drag Brake: 0 Pinion: 27 Spur: 75
Throttle Profile: 30 Battery: IP 6000mAh
Battery Weight: 215g

Tires

	Front	Rear
Thread:	PL Electron	PL Positron
Compound:	MC	MC
Insert:	Stock	Stock Zeke Mod
Sauce:	LW Yellow	LW Yellow

Notes: PL Axis Body, RCSS Ti Turnbuckles, screws and ceramic bearings.

Chassis

Electronics Plate Brass, 36g Carbon
Battery Plate 19g 26g 37g
Rear Ballast 16g 25g
C-Pivot Block Brass, 20g Aluminum
Total Weight: 1540g
FR: % RR: %